

Scottish Borders Council
Town And Country
Planning (Scotland) Act
1987

APPROVED

subject to the
requirements of the
associated Decision
Notice

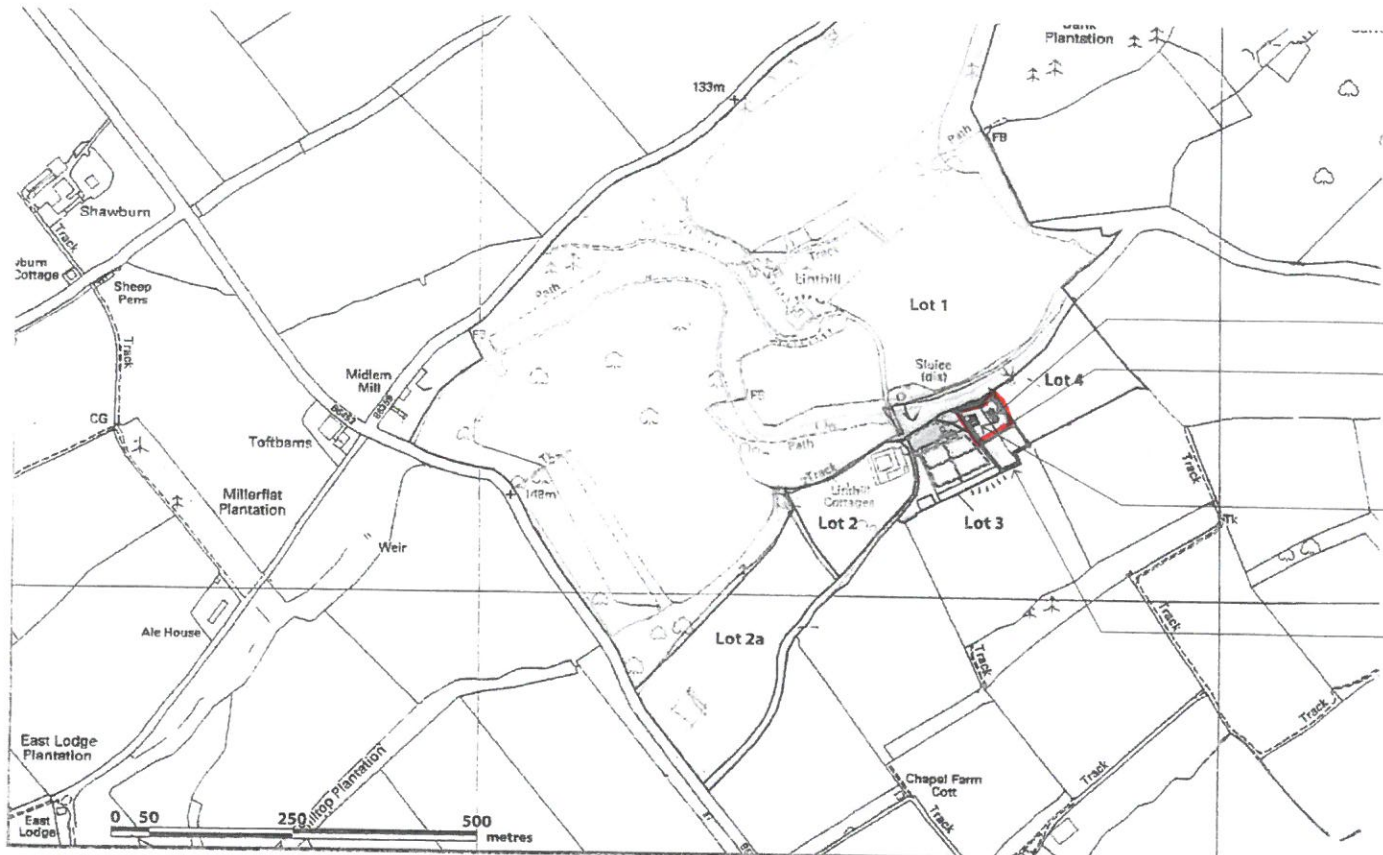

PROPOSED GARAGE/WORKSHOP BUILDING

GARDEN GROUND OUTLINED IN RED

EXISTING HOUSE 'RIVER COTTAGE'

SITE OWNED BY APPLICANTS OUTLINED IN BLUE

This plan is only for the guidance of intending purchasers. Although believed to be correct, its accuracy is not guaranteed and it does not form any part of a contract. It is reproduced by permission of Ordnance Survey on behalf of The Controller of Her Majesty's Stationery Office. Copyright. All rights reserved. Licence 1.

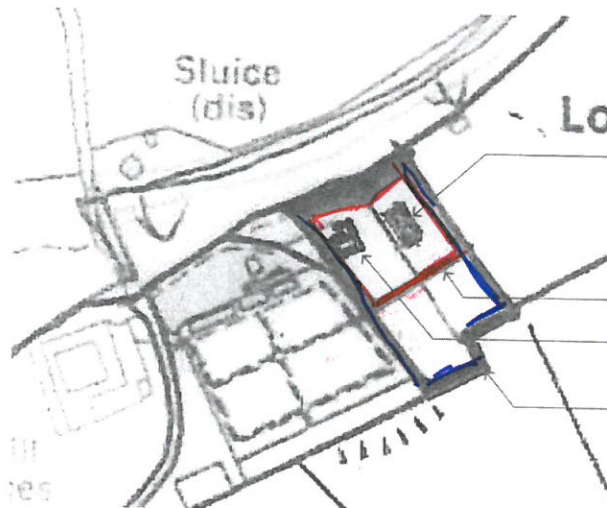

PROPOSED GARAGE/WORKSHOP BUILDING

GARDEN GROUND OUTLINED IN RED

EXISTING HOUSE 'RIVER COTTAGE'

SITE OWNED BY APPLICANTS OUTLINED IN BLUE

1:1000 - DRAWING FOR BUILDING DESIGN

client Mr & Mrs G. Malcolm
project PROPOSED GARAGE/WORKSHOP
RIVER COTTAGE
LINTHILL, MELROSE
site LOCATION PLAN

dep no 141447/PL/LOC. scale 1:1000 scale bar 10m date 10.10.16

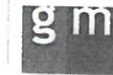

GORDON MELROSE ARCHITECTS
BUILDING DESIGN
6 MARKET PLACE
SELKIRK
BORDERS
TD7 4BT

T. 01750 725333
F. 01750 725444
E. gordon@gmbuildingdesign.co.uk
www.gmbuildingdesign.co.uk